



CHARMOUTH - LUXURY LODGE

Light, bright, contemporary and fresh, the new Charmouth offers a feast for the eyes with its on-trend botanical theme.



The striking design style spells pure luxury however, style in no way compromises functionality, and the Charmouth is a surprisingly affordable holiday home too!

Retaining the popular exterior features of its predecessor, such as sliding patio doors to the front elevation and feature CanExel cladding, but with a bold new colourway for 2024, the Charmouth is a holiday home with plenty of kerb appeal!

Inside the living space combines clean lines with beautiful, bold botanical prints and the result is exquisite!

If you're looking for an affordable and practical holiday home with impact and style, this may well be the one!

Stay warm and cosy throughout the year with BS 3632 Residential Specification now available on this model!

This model is now available in BS 3632 – the British Standard for residential park homes. A caravan holiday home built to BS 3632 means better insulation and energy efficiency so you can enjoy it throughout the year.



Scan the code
to view in 3D

Options

SIZES
42' x 14'

BEDS
2DB, 3DB

BATHROOM
1

DESCRIPTION
With Fully enclosed shower with sliding glass door

MINIMUM SIZE
42' x 14'

MAXIMUM SIZE
42' x 14'

SKU / MODEL
RCL007

Sep 2023



A place to relax...

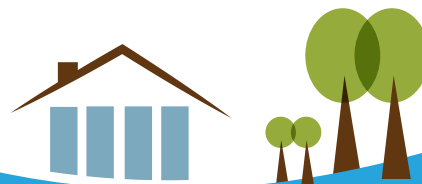



CHARMOUTH - LUXURY LODGE

Exterior

Sliding patio doors to the front elevation
Rigid Claystone vinyl exterior cladding
Feature black CanExel cladding to the front elevation
Black fascias, soffits, gutters and downpipes
White uPVC double glazing

Construction

Built to BS 3632 residential specification (14' models only)
Fully insulated floors, walls and roof
Twin axle pre-galvanised steel chassis with detachable tow bar
Vaulted ceilings throughout
Minimum ceiling height of 7ft
Gas combi central heating system
Satin chrome sockets throughout

Lounge

Freestanding sofa and sofa bed with scatter cushions
Coffee table, TV unit and bookcase
Media / fire unit with contemporary electric fire
Feature pendant lighting (also to kitchen / dining area)
USB socket

Kitchen / Dining Area

High quality, domestic sized kitchen units
Integrated fridge freezer, microwave and slimline dishwasher
Oven and 4-burner hob with curved glass cooker hood
Venetian Blind
Freestanding dining table and chairs

Master Bedroom

King-size (lift-up) bed to master bedroom with wall-mounted headboard
Double fitted wardrobe
Dressing table and bedside cabinets
Feature pendant lighting
Feature wallboard
USB socket
En-suite with shower

Twin Bedroom

3ft beds to two bed models
TV point and USB socket
Fitted wardrobe and bedside cabinet

Bathroom / En-suite

Fully enclosed shower with sliding glass door



A place to relax...





CHARMOUTH - LUXURY LODGE

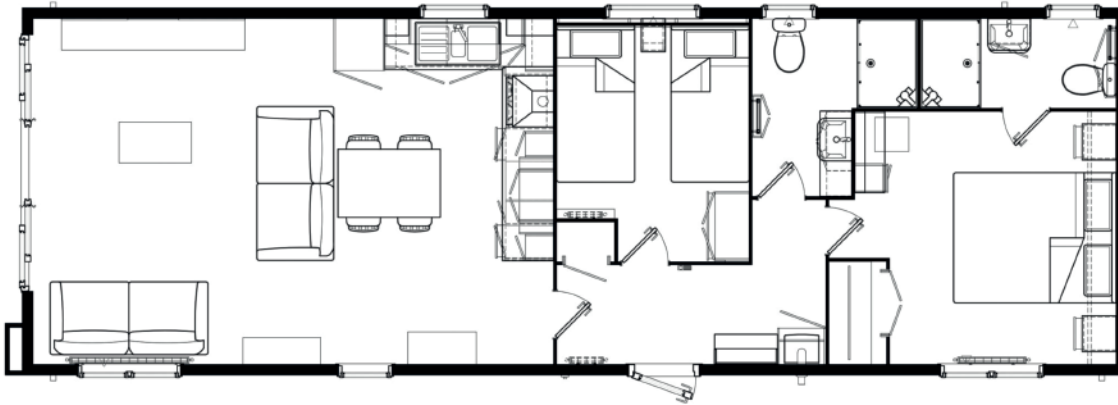

42' x 14'
2DB



42' x 14'
3DB



Scan the code
to view in 3D



SEE OUR WEBSITE FOR MORE
PHOTOS AND INFORMATION

A place to relax...

